

Picture That

CONSULTANTS

ART SELECTIONS – MARCH 29, 2023 - FINAL

HARTFORD HEALTHCARE FACILITY

Hartford Healthcare Neuro/GI Motility
215 Elm Street, Suite 101, Old Saybrook, CT 06475

CONTACT:

Jennifer Murnane

Director of Ambulatory Services
Concord Healthcare
30 Frandel Drive, Avon, CT 06001
Cell: 860.368.9476
Email: jmurnane@chd-inc.com

Christine Sniadack-Lopez

Director Ambulatory Development
and Facilities Integration
Hartford Healthcare Strategy & Planning
129 Patricia M. Genova Drive, Newington, CT 06111
Cell: 860.604.1857
Email: Christine.Sniadack@hhchealth.org

Floorplan



●	- Corridors A & B	5
●	- Seca Scale Room	1
●	- Educat/B.H. Room	1
●	- Waiting Room	1
Art Total		8

Picture That
CONSULTANTS

203-977-8203
www.picturethatconsultants.com

3/29/2023, 1:00 PM

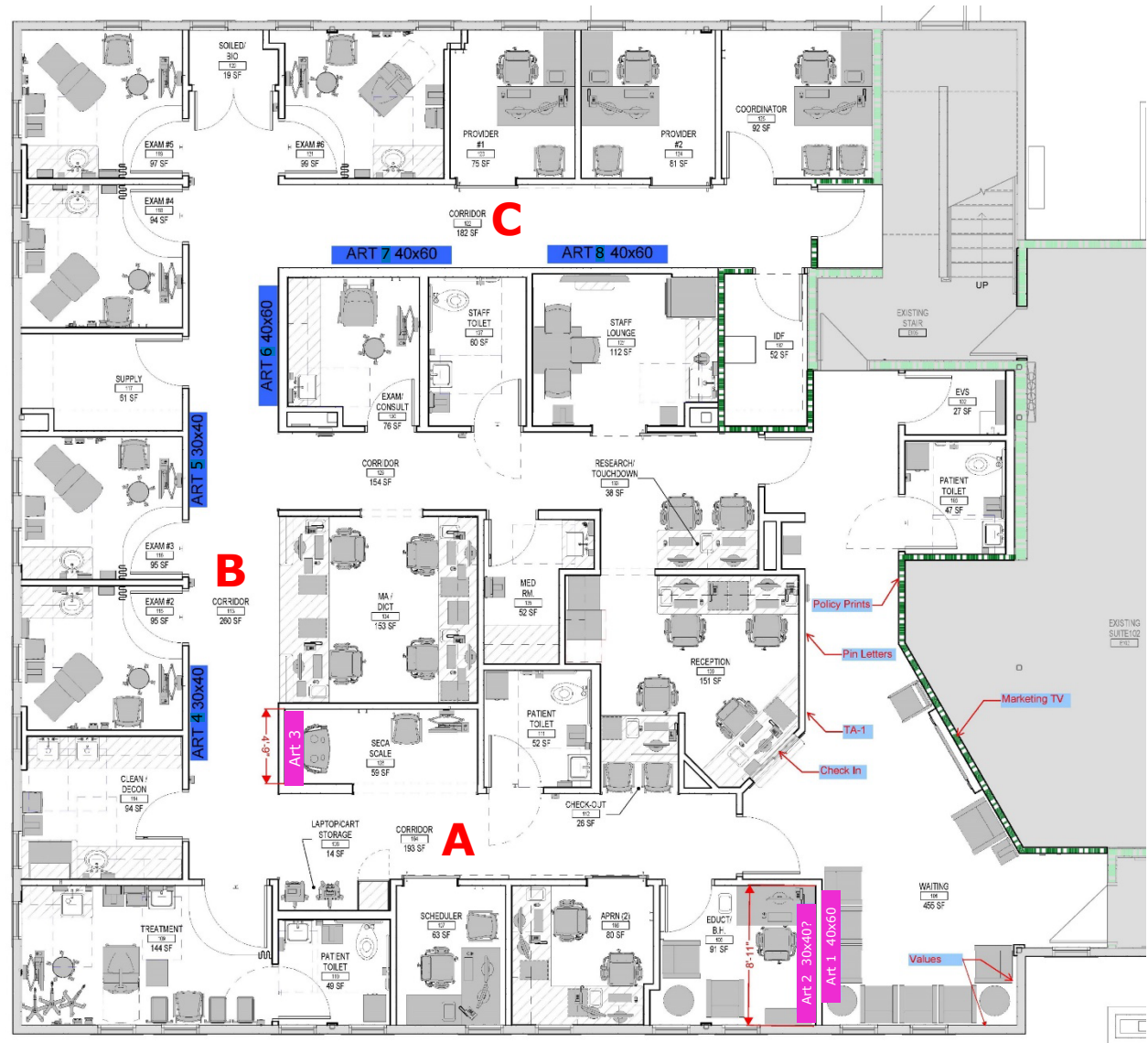

Art Selections - Corridor A

A

Art 1



*Fenwick Lighthouse in Old Saybrook, CT
by Leonard Farrell*

A

Art 2



*Connecticut River, Old Saybrook
by Ann Talbot*

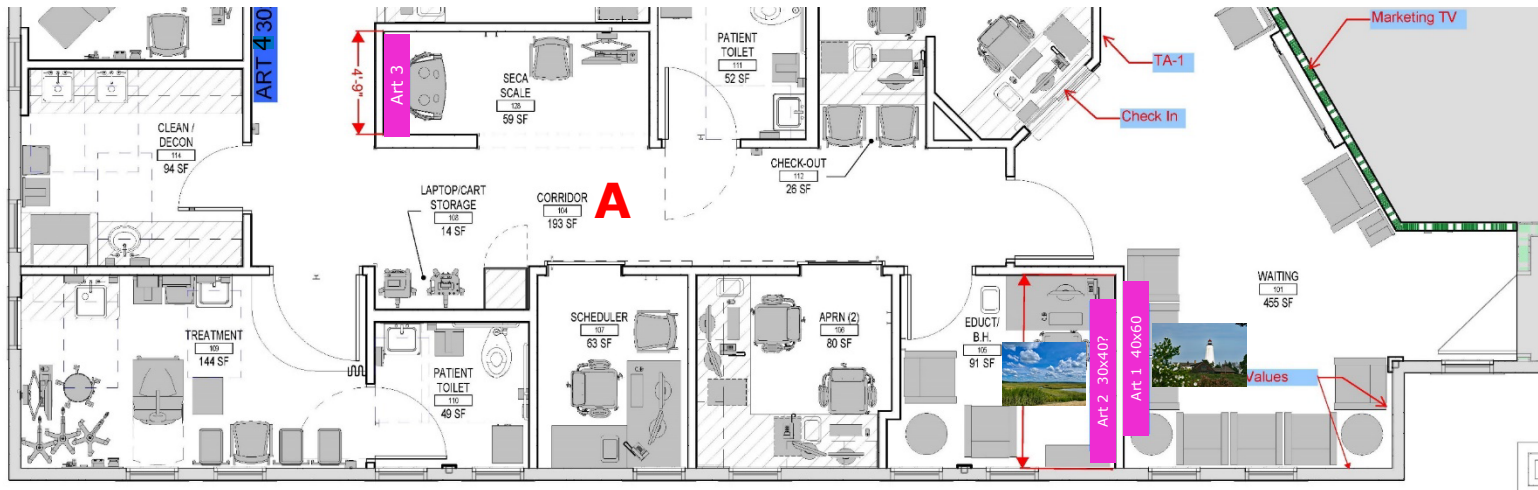

Art Selections - Corridor A

A

Art 3



Boats Moored at Marina, Old Saybrook, CT
by Barry Wniker

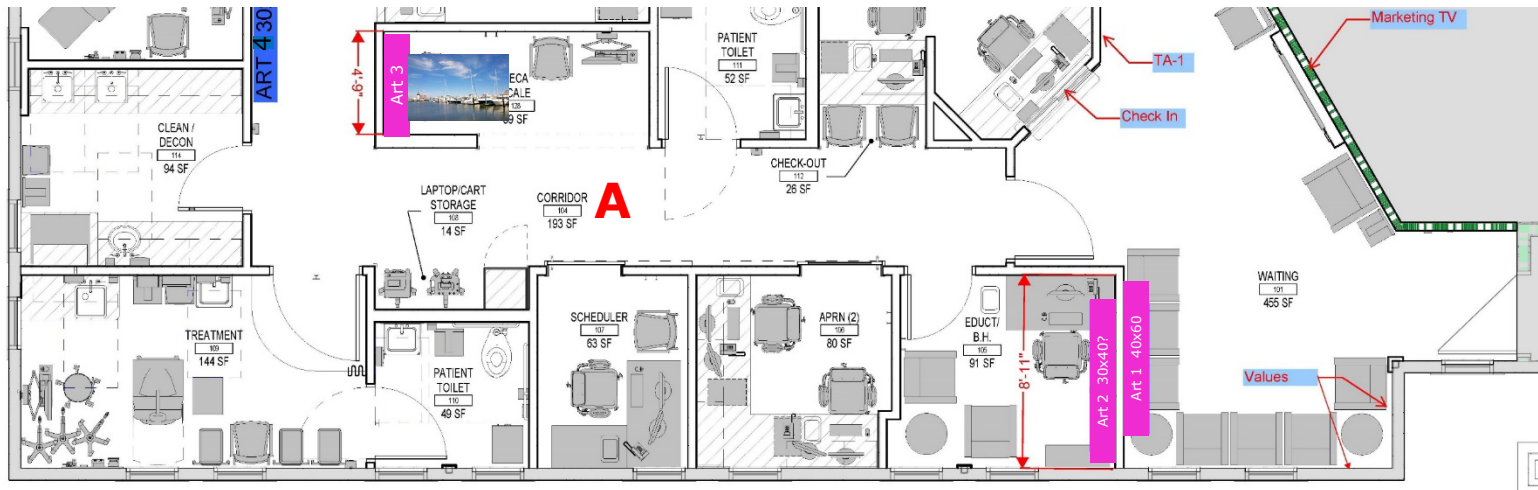

Art Selections - Corridor B

B

Art 4



Old Saybrook Lighthouse at Sunset
by Mcpuckette

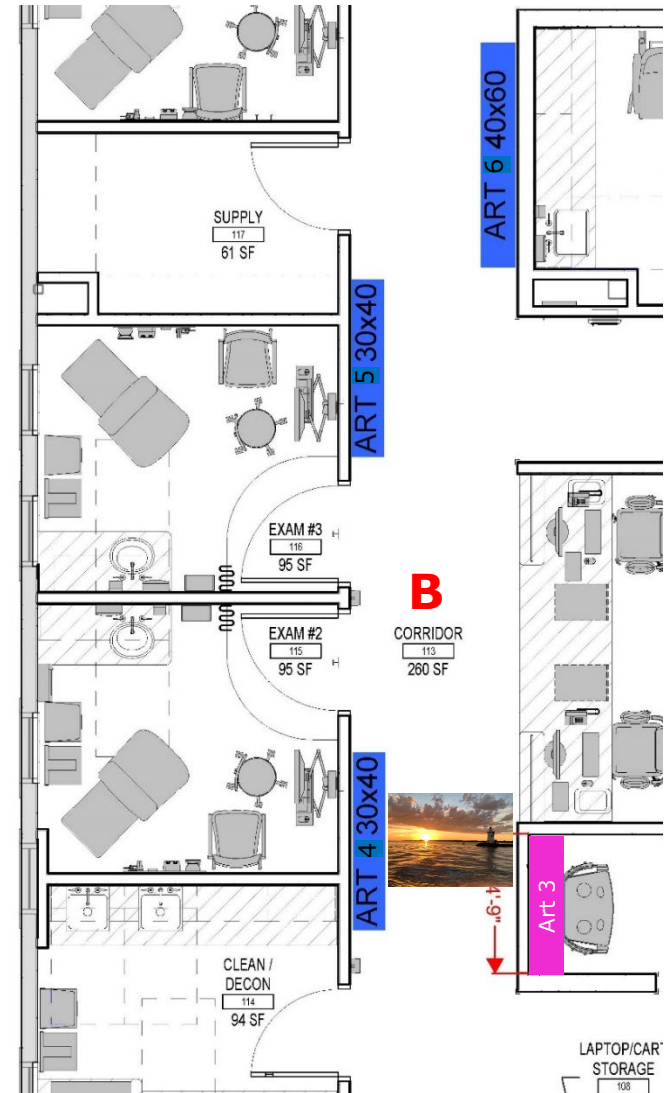

Art Selections - Corridor B

B

Art 5



*Water Between Marsh Grass, Old Saybrook, CT
by Barry Winiker*

B

Art 6



*Lynde Point Lighthouse, Old Saybrook,
Connecticut, USA by Lucky Photographer*

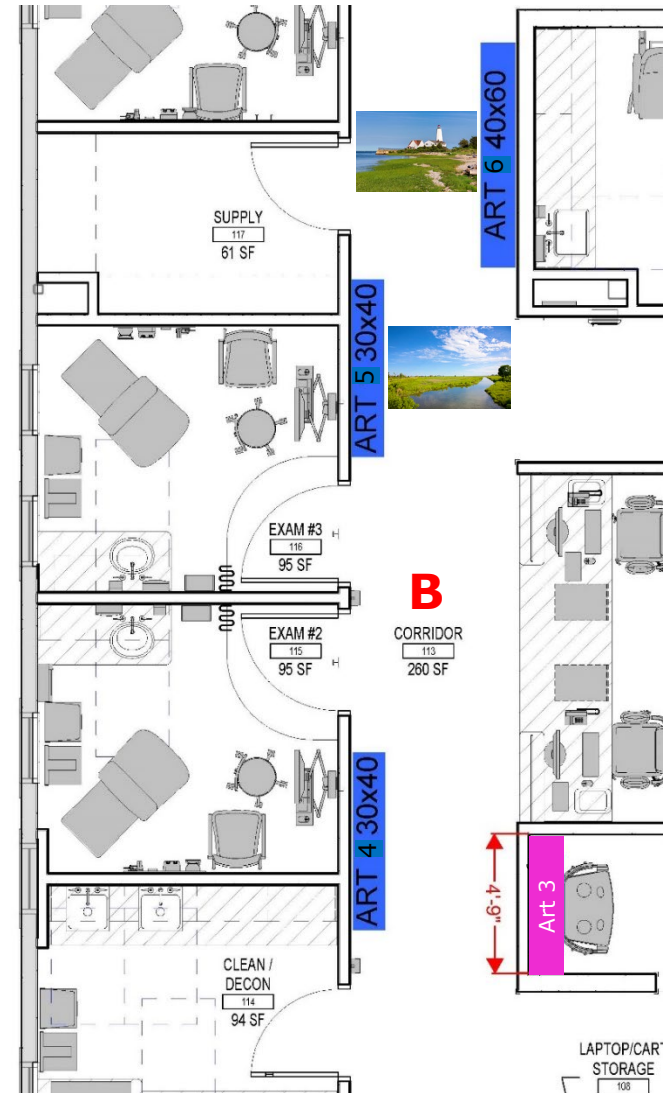

Art Selections - Corridor C

C

Art 7



Connecticut River by Alexeys

C

Art 8



Saybrook Point – Old Saybrook, CT by Joann Vitali

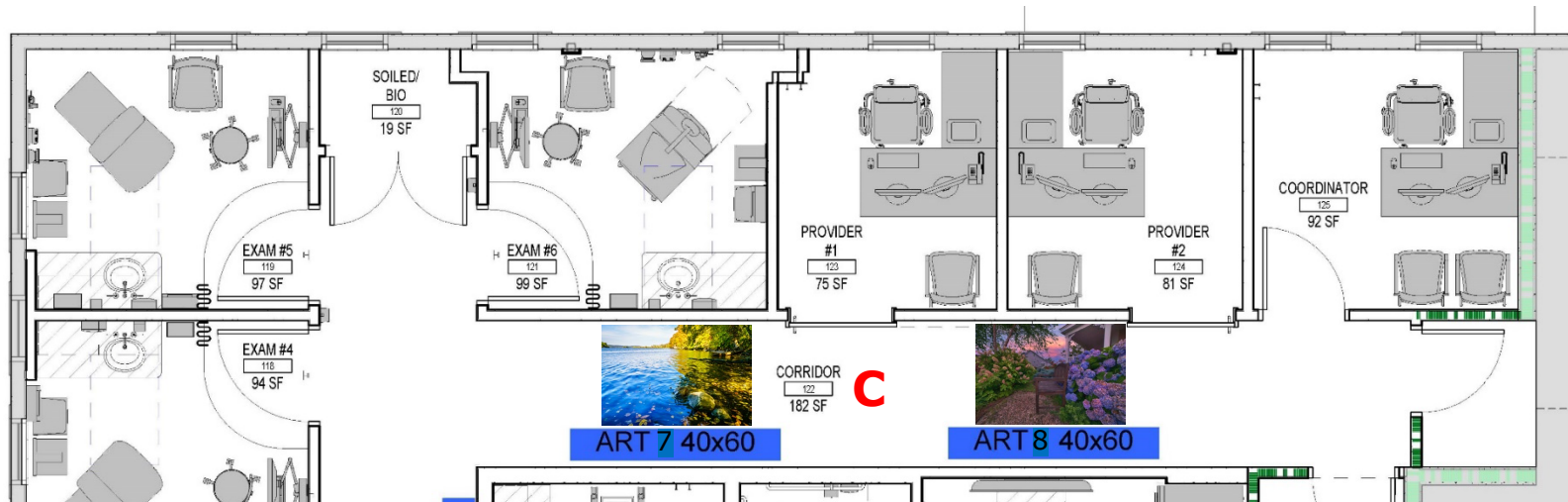

Contact Us

Picture That, LLC

fineart@picture-that.com

www.picturethatconsultants.com

Main: (203) 977-8203

Direct: (203) 253-0294

Northeast Region

Soundview Plaza

1266 East Main Street, Suite 700R
Stamford, CT 06902



Mid-Atlantic Region

Evening Star

1101 Pennsylvania Ave NW, Suite 300
Washington, DC 20004



Southeast Region

The Atlantic

270 17th Street, NW, Unit 2110
Atlanta, GA 30336

