

REFLECTED CEILING PLAN KEY NOTES

- ◇ PROVIDE ALL PRICING FOR SEAMLESS BACKDROP PROJECTION SCREEN ON WEST.
- ◇ SEE DETAIL 11A-R02.00 FOR GWT & ACT TRANSITION.

REFLECTED CEILING PLAN NOTES

- FOR ADDITIONAL NOTES AND LEGENDS, REFER TO SHEET A-002.
1. TYPICAL CEILING HEIGHT IS 9'-0" A.F. U.O.N.
 2. CENTER ALL LIGHT FIXTURES, SPRINKLER HEADS AND OTHER DEVICES IN ACOUSTICAL CEILING TILE, U.O.N.
 3. CENTER ACOUSTICAL GRID IN SPACE U.O.N.
 4. LOCATE DRYWALL CONTROL JOINTS EVERY 20'-0" IN GYPSUM BOARD CEILING. ALIGN CONTROL JOINT WITH CORNER OF WALLS AND/OR CENTERLINE OF COLUMN.
 5. CONFIRM WITH ARCHITECT, EXACT LOCATION, PENDANT LENGTH AND FINISH MOUNTING HEIGHT FOR ALL SUSPENDED LIGHT FIXTURES.
 6. TYPICAL GWS CEILING FINISH P-11, U.O.N. CEILINGWALL PAINT FINISH TRANSITIONS TO OCCUR ONLY AT AN INSIDE CORNER. NO TAPE LINES OR OUTSIDE CORNER FINISH TRANSITIONS. REVIEW FINISH TRANSITIONS WITH ARCHITECT IN FIELD PRIOR TO FINISHING.
 7. GWS HEADERS AT DEMOUNTABLE PARTITIONS TO BE 8'-11 1/4" U.O.N.
 8. ALL 2x2 CEILING TILES ARE ACT-2, U.O.N.

1 REFLECTED CEILING PLAN - LEVEL 3
1/8" = 1'-0"

9/18/2014 12:14:13 PM

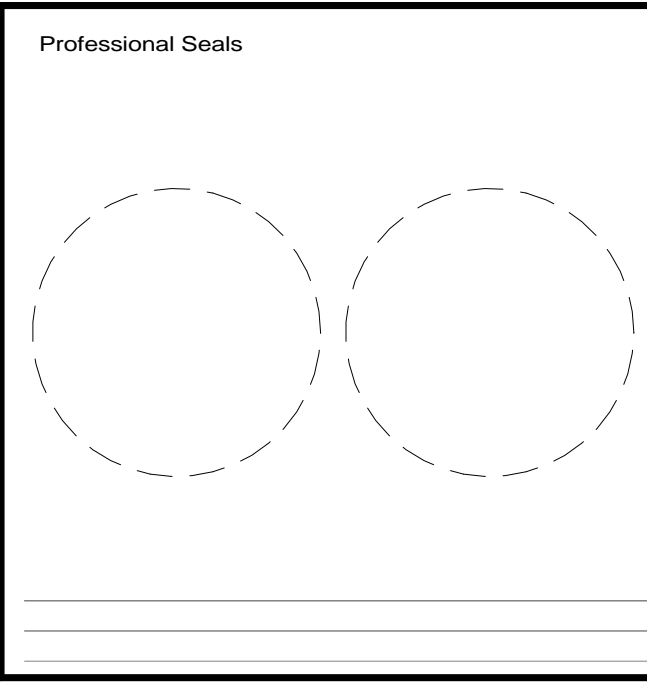
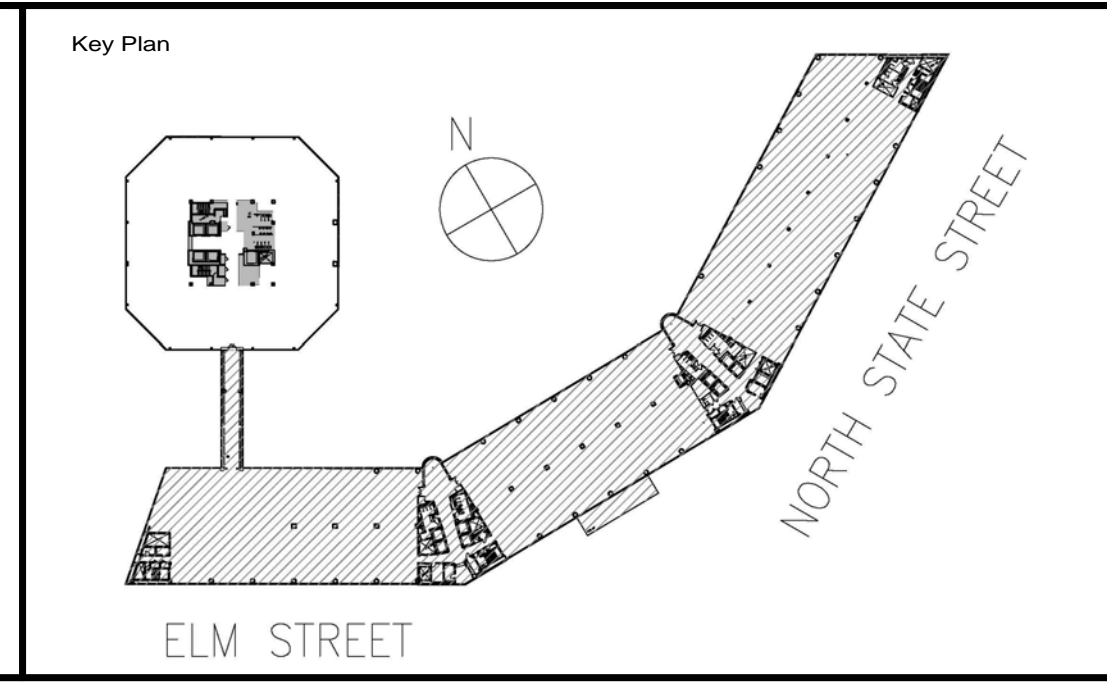

Project Scope
DELOITTE STAMFORD

Prepared for
Deloitte Stamford
695 E. Main Street
Stamford, CT 06904

Contract No: 13.07062.00



695 E. Main Street
Stamford, CT 06904

hok
1065 Avenue of The Americas, 6th Floor
New York, NY 10018
Voice: 1 212 1 744 1 1200
Fax: 1 212 1 633 1 1163
hok.com

In Association with
JACOBS KLING STUBBINS
Jacobs Kling Stubbins
MEFP Engineers
2301 Chesnut Street
Philadelphia, PA 19103
Voice: 1 215 1 569 1 2900
Fax: 1 215 1 569 1 5963
Jacobs.com

LIGHTING WORKSHOP
Lighting Workshop
Lighting Consultants
20 Jay Street, Suite 600
Brooklyn, NY 11201
Voice: 1 212 1 796 1 6510
Fax: 1 212 1 796 1 2072
lgworkshop.com

No.	Issue Description	Date

No.	Revision Description	Date
1	SCHEMATIC DESIGN	2014.01.10
2	DESIGN DEVELOPMENT	2014.02.28
3	EARLY BID PACKAGE	2014.04.02
4	PROGRESS SET	2014.04.15
5	ISSUE FOR BID	2014.04.22
6	ISSUE FOR PERMIT	2014.04.28
7	ADDENDUM #1	2014.05.12
8	BULLETIN #2	2014.06.09
9	BULLETIN	Date 12

Drawn by: Author Reviewed by: Checker
Project No: 13.07062.00

REFLECTED CEILING PLAN 3RD FLOOR

Original drawing is 36" x 48". Scale applies accordingly if reduced.
Sheet Number: **A-303.00**