

FURNITURE PLAN NOTES

1. ALL PRIVATE OFFICES ON 2ND, 3RD & 5TH FLOORS TO BE PO-2. SEE ENLARGED PLAN FOR FURNITURE INFO ON EACH LEVEL. U.O.N.
2. ALL PRIVATE OFFICES ON 4TH & 6TH FLOORS TO BE PO-2A. SEE ENLARGED PLAN FOR FURNITURE INFO ON EACH LEVEL.
3. ALL WORKSTATIONS TO BE WS-1. U.O.N.
4. ALL OPEN OFFICE AREA TASK CHAIRS TO BE CH-9A.
5. PROVIDE PRIVACY SCREEN @ ALL OFFICE @ ON 3RD & 4TH FLOORS.
6. SEE ENLARGED PLANS FOR OFFICE @ FURNITURE ON 3RD AND 4TH FLOORS.
7. PROVIDE BLOCKING 16 GAUGE METAL PLATE IN PARTITIONS FOR WALL MOUNTED FURNITURE AS REQUIRED. COORDINATE LOCATIONS AND BLOCKING TYPE WITH FURNITURE VENDOR.
8. REFER TO FINISH PLANS AND ELEVATIONS FOR EXTENT / LOCATION OF FULL HEIGHT MARKER BOARD AND FABRIC WRAPPED PANELS.
9. PROVIDE POWER PO@ AT 4P MEETING ROOMS & SINGLE OFFICES

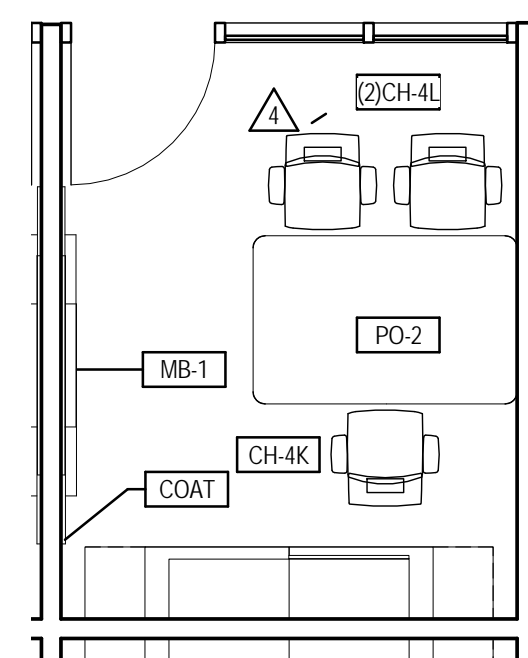

2 TYPICAL OFFICE FURNITURE PLAN - LEVEL 2 (RED ACCENT OFFICE)
1/4" = 1'-0"

1 FURNITURE PLAN - LEVEL 2
1/8" = 1'-0"

9/18/2014 12:12:23 PM

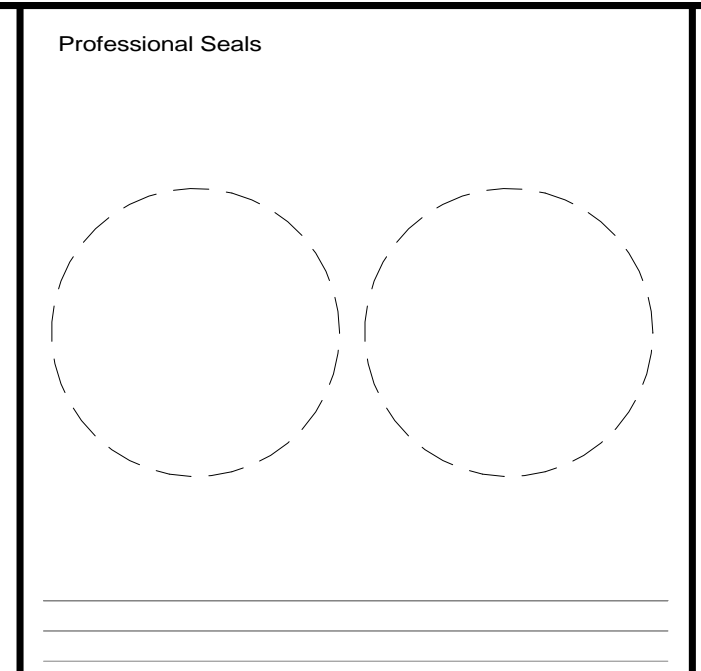
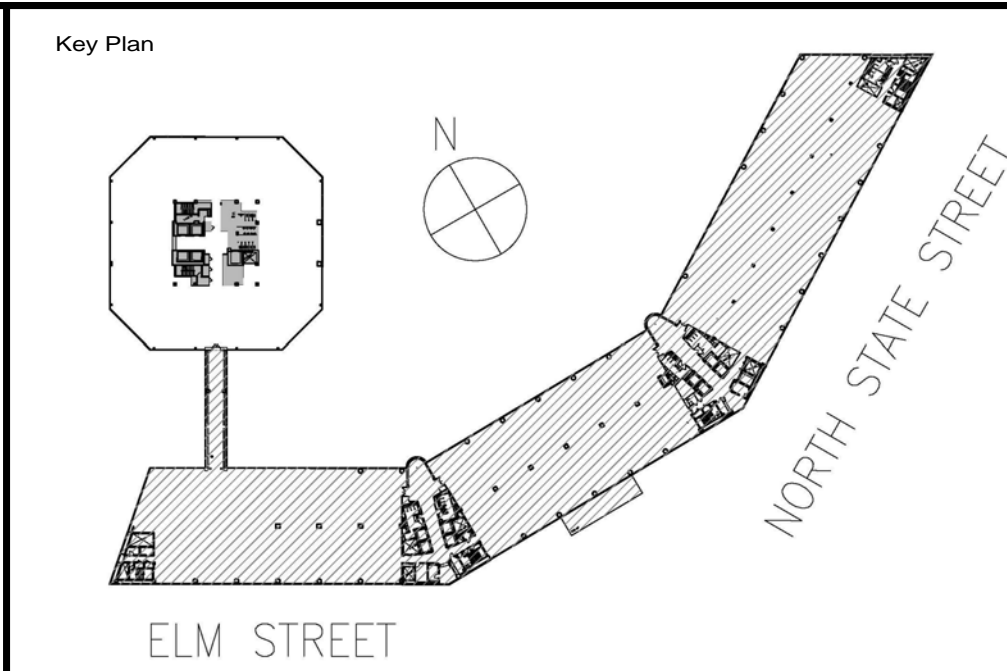

Project Scope
DELOITTE STAMFORD

Prepared for
Deloitte Stamford
695 E. Main Street
Stamford, CT 06904

Contract No: 13.07062.00

Deloitte
695 E. Main Street
Stamford, CT 06904

hok
1065 Avenue of The Americas, 6th Floor
New York, NY 10018
Voice: 1 212 1 741 - 1200
Fax: 1 212 1 633 - 1163
hok.com

In Association with
JACOBS KLING STUBBINS
Jacobs KlingStubbins
MEPP Engineers
2301 Chestnut Street
Philadelphia, PA 19103
Voice: 1 215 1 569 - 2900
Fax: 1 215 1 569 - 5963
Jacobs.com

LIGHTING WORKSHOP
Lighting Workshop
Lighting Consultant
20 Jay Street, Suite 600
Brooklyn, NY 11201
Voice: 1 212 1 796 - 6510
Fax: 1 212 1 796 - 2072
lgworkshop.com

No.	Issue Description	Date

No.	Revision Description	Date
1	PROGRESS SET	2014.04.15
2	ISSUE FOR BID	2014.04.22
3	ISSUE FOR PERMIT	2014.04.28
4	BULLETIN #2	2014.06.09
5	BULLETIN #3	2014.06.25

Drawn by: Author Reviewed by: Checker
Project No: 13.07062.00

Sheet Title:
**FURNITURE PLAN
PARTIAL 2ND FLOOR**

Original drawing is 36" x 48". Scale applies accordingly if reduced.
Sheet Number:
A-202.30
Sheet of