

REFLECTED CEILING PLAN KEY NOTES

- ◆ PROVIDE ALT PRICING FOR SEAMLESS BACKDROP PROJECTION SCREEN ON WEST.
- ◆ SEE DETAIL 11A-R20.00 FOR GWT & ACT TRANSITION

REFLECTED CEILING PLAN NOTES

FOR ADDITIONAL NOTES AND LEGENDS, REFER TO SHEET A.002.

1. TYPICAL CEILING HEIGHT IS 9'-0" A.F. U.O.N.
2. CENTER ALL LIGHT FIXTURES, SPRINKLER HEADS AND OTHER DEVICES IN ACOUSTICAL CEILING TILE U.O.N.
3. CENTER ACOUSTICAL CORNERS SPACE U.O.N.
4. LOCATE DRYWALL CONTROL JOINTS EVERY 20'-0" IN GYPSUM BOARD CEILING. ALSO CONTROL JOINT WITH CORNER OF WALLS AND/OR CENTERLINE OF COLUMN.
5. CONFIRM WITH ARCHITECT EXACT LOCATION, PENDANT LENGTH AND FRAMOUNTING HEIGHT FOR ALL SUSPENDED LIGHT FIXTURES.
6. TYPICAL GWT CEILING FINISH P-11 U.O.N. CEILING/WALL PAINT FINISH TRANSITIONS TO OCCUR ONLY AT AN INSIDE CORNER. NO TAP LINES OR OUTSIDE CORNER FINISH TRANSITIONS. REVIEW FINISH TRANSITIONS WITH ARCHITECT IN FIELD PRIOR TO FINISHING.
7. GWT HEADERS AT DEMOUNTABLE PARTITIONS TO BE #1-1/4" U.O.N.
8. ALL 2x2 CEILING TILES ARE ACT-1 U.O.N.

1 REFLECTED CEILING PLAN - LEVEL 5
1/8" = 1'-0"

9/18/2014 12:14:47 PM

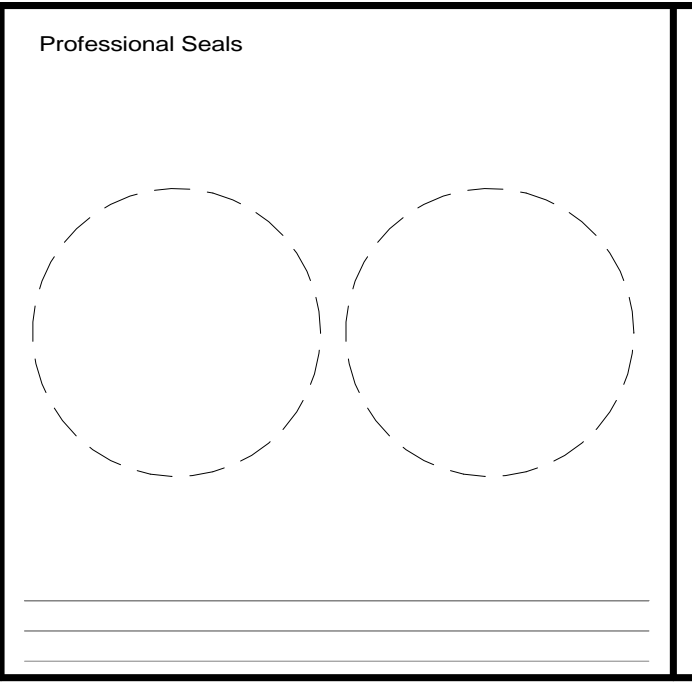
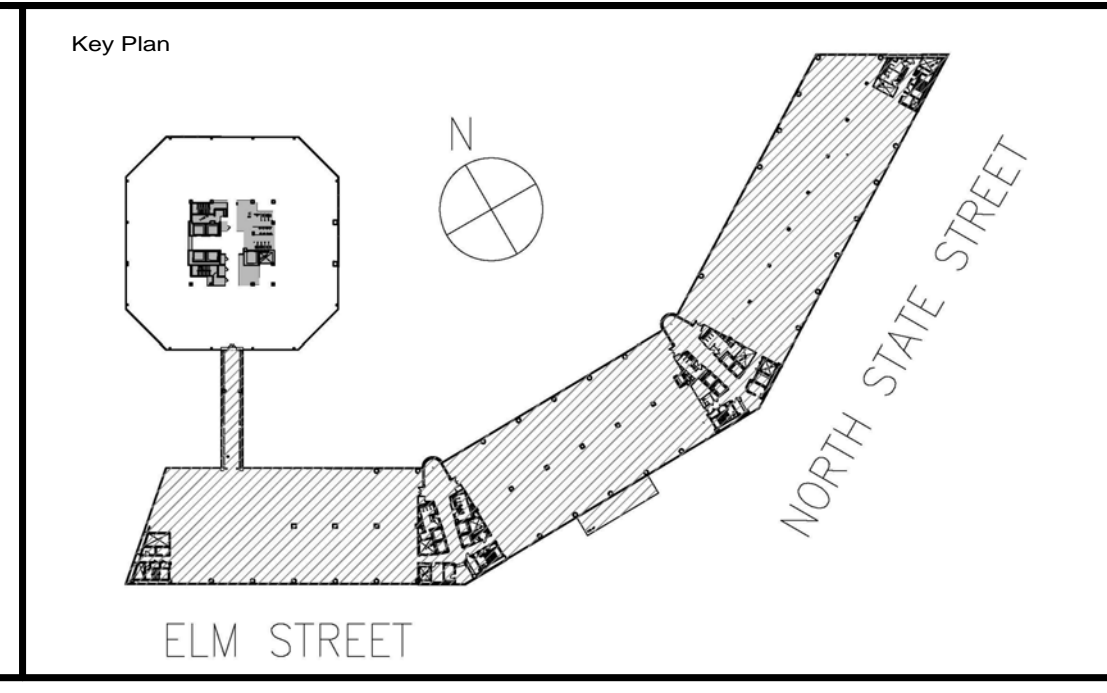

Project Scope
DELOITTE STAMFORD

Prepared for
Deloitte Stamford
695 E. Main Street
Stamford, CT 06904

Contract No: 13.07062.00

Deloitte

695 E. Main Street
Stamford, CT 06904

JKK

1065 Avenue of The Americas, 6th Floor
New York, NY 10018
Voice: 1 212 744 1200
Fax: 1 212 633 1163
hok.com

In Association with
JACOBS KLING STUBBINS
MEPP Engineers
2301 Chestnut Street
Philadelphia, PA 19103
Voice: 1 215 569 2900
Fax: 1 215 569 5963
Jacobs.com

LIGHTING WORKSHOP
Lighting Workshop
Lighting Consultant
20 Jay Street, Suite 600
Brooklyn, NY 11201
Voice: 1 212 796 6510
Fax: 1 212 796 2072
lgworkshop.com

No.	Issue Description	Date	No.	Revision Description	Date
1	SCHEMATIC DESIGN	2014.01.10	1	SCHEMATIC DESIGN	2014.01.10
2	DESIGN DEVELOPMENT	2014.02.28	2	DESIGN DEVELOPMENT	2014.02.28
3	EARLY BID PACKAGE	2014.04.02	3	EARLY BID PACKAGE	2014.04.02
4	PROGRESS SET	2014.04.15	4	PROGRESS SET	2014.04.15
5	ISSUE FOR BID	2014.04.22	5	ISSUE FOR BID	2014.04.22
6	ISSUE FOR PERMIT	2014.04.28	6	ISSUE FOR PERMIT	2014.04.28
7	ADDENDUM #1	2014.05.12	7	ADDENDUM #1	2014.05.12
8	BULLETIN #2	2014.06.09	8	BULLETIN #2	2014.06.09
9	BULLETIN	Date 12	9	BULLETIN	Date 12

Drawn by:	Author	Reviewed by:	Checker
Project No:	13.07062.00		
Sheet Title:	REFLECTED CEILING PLAN 5TH FLOOR		
Original Drawing is:	36" x 48" Scale unless otherwise noted		
Sheet Number:	A-305.00		

Drawn by: Author Reviewed by: Checker

Project No: 13.07062.00

Sheet Title: REFLECTED CEILING PLAN 5TH FLOOR

Original Drawing is: 36" x 48" Scale unless otherwise noted

Sheet Number: **A-305.00**