



Trinity Health  
Of New England

Saint Mary's  
Hospital

**Project 7:**  
O'Brien Building  
*Waiting Area*

Presented - 02-26-20



We Develop Your **Future**

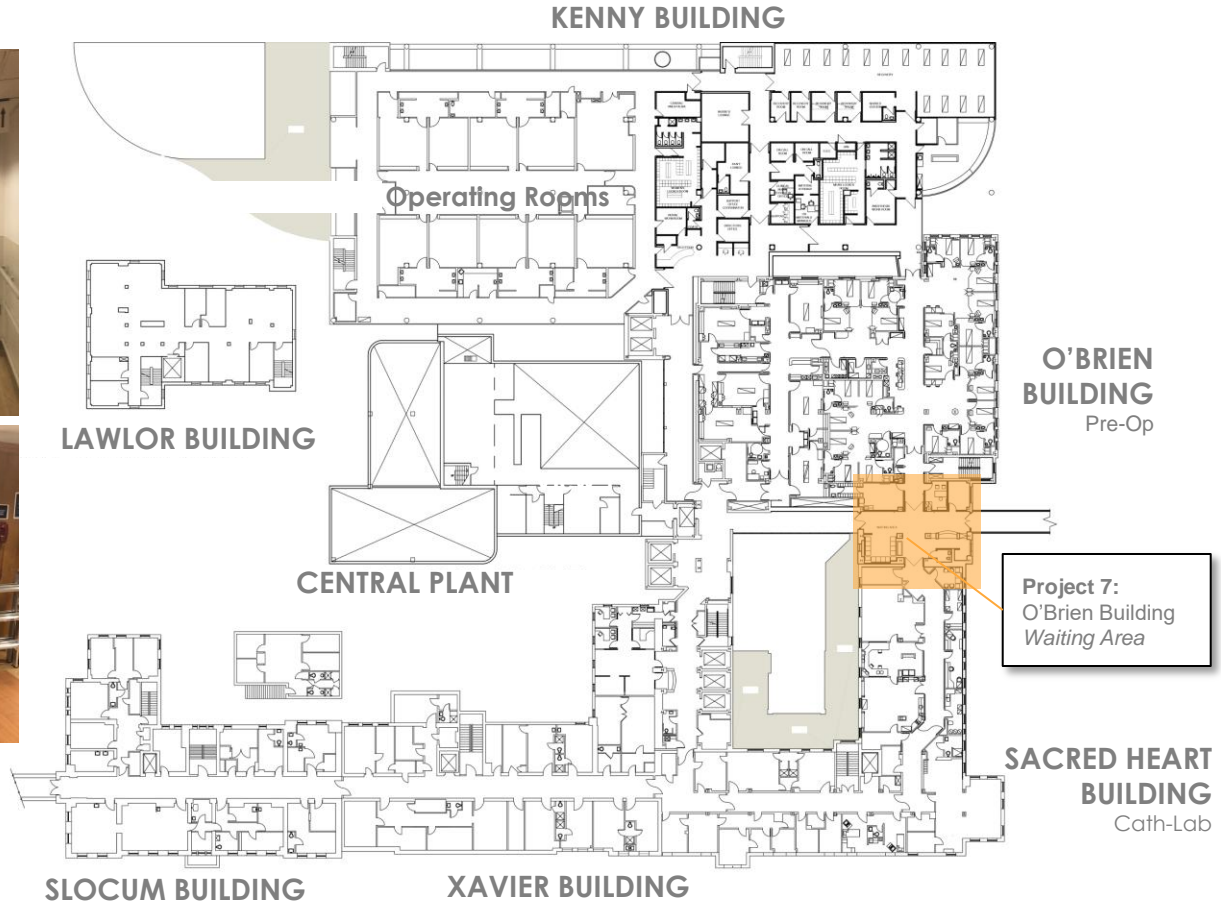

ST. MARY'S HOSPITAL FLOOR 2

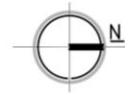

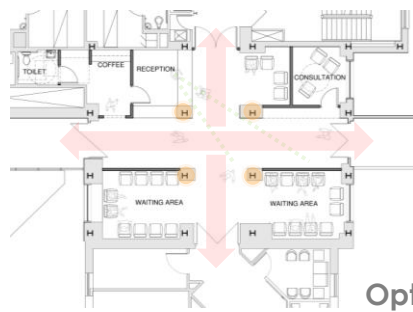

Option 1

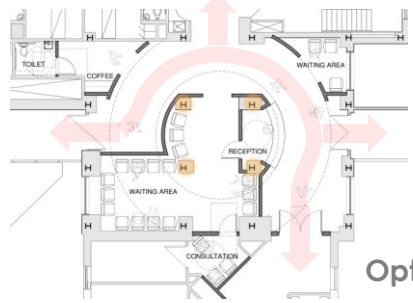

Option 2

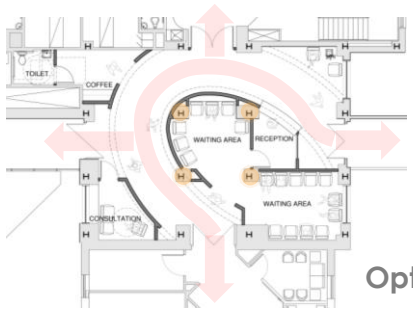

Option 3

CIRCULATION OPTIONS

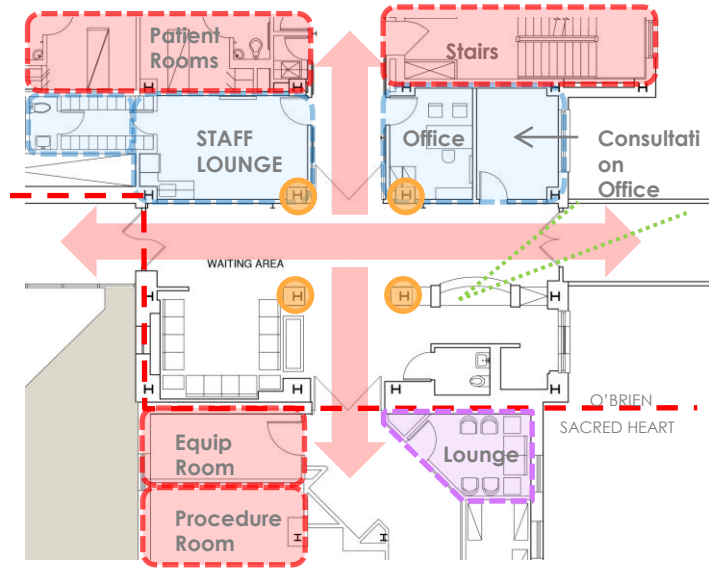

- Allowed areas expansion areas
- Possible expansion areas
- Prohibited expansion areas

- Primary Circulation Corridors
- Structural Obstructions
- Visibility Issues
- Firewall

- Other Challenges**
- Limited Seating
  - Low Ceilings



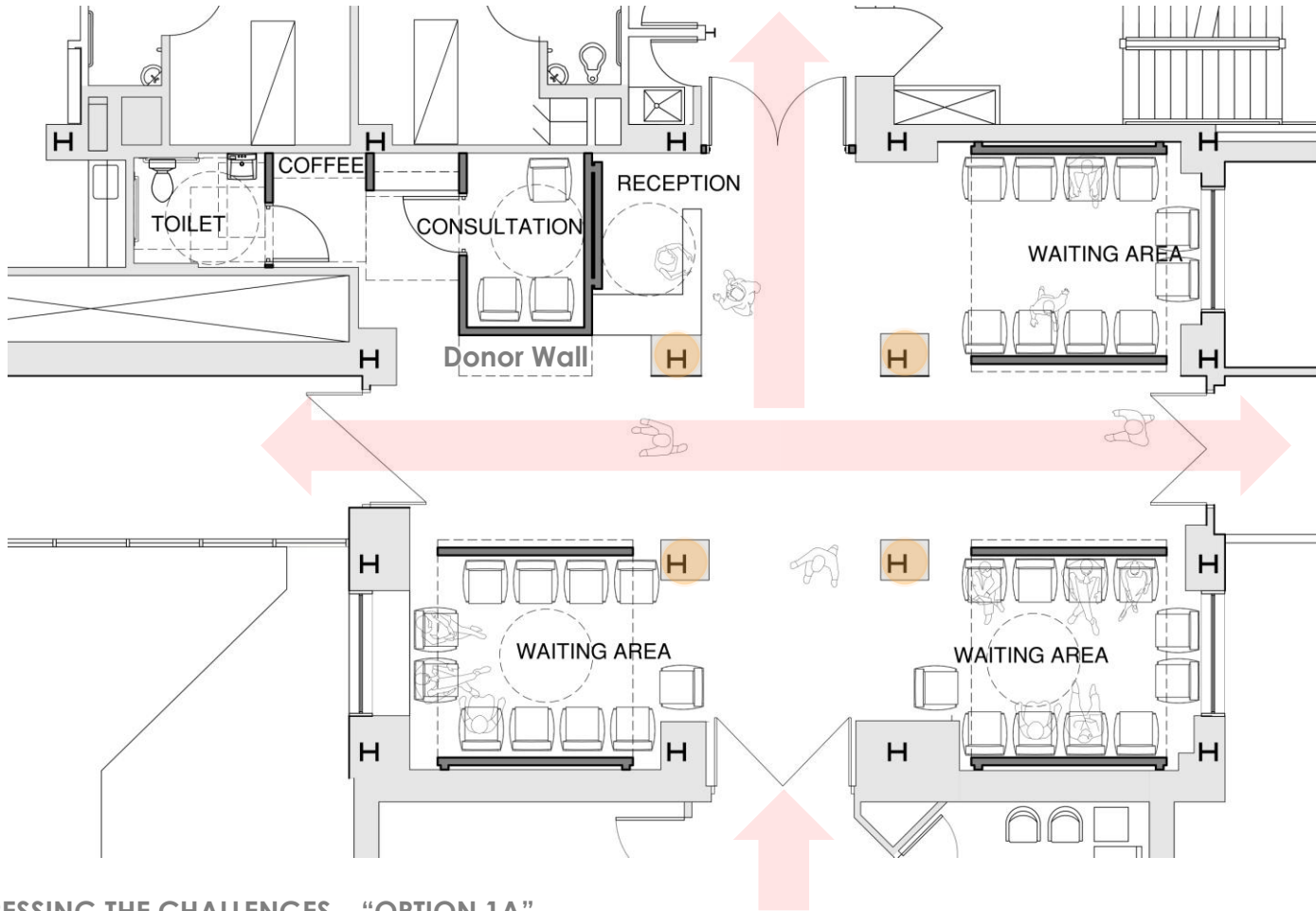

ADDRESSING THE CHALLENGES – “OPTION 1A”

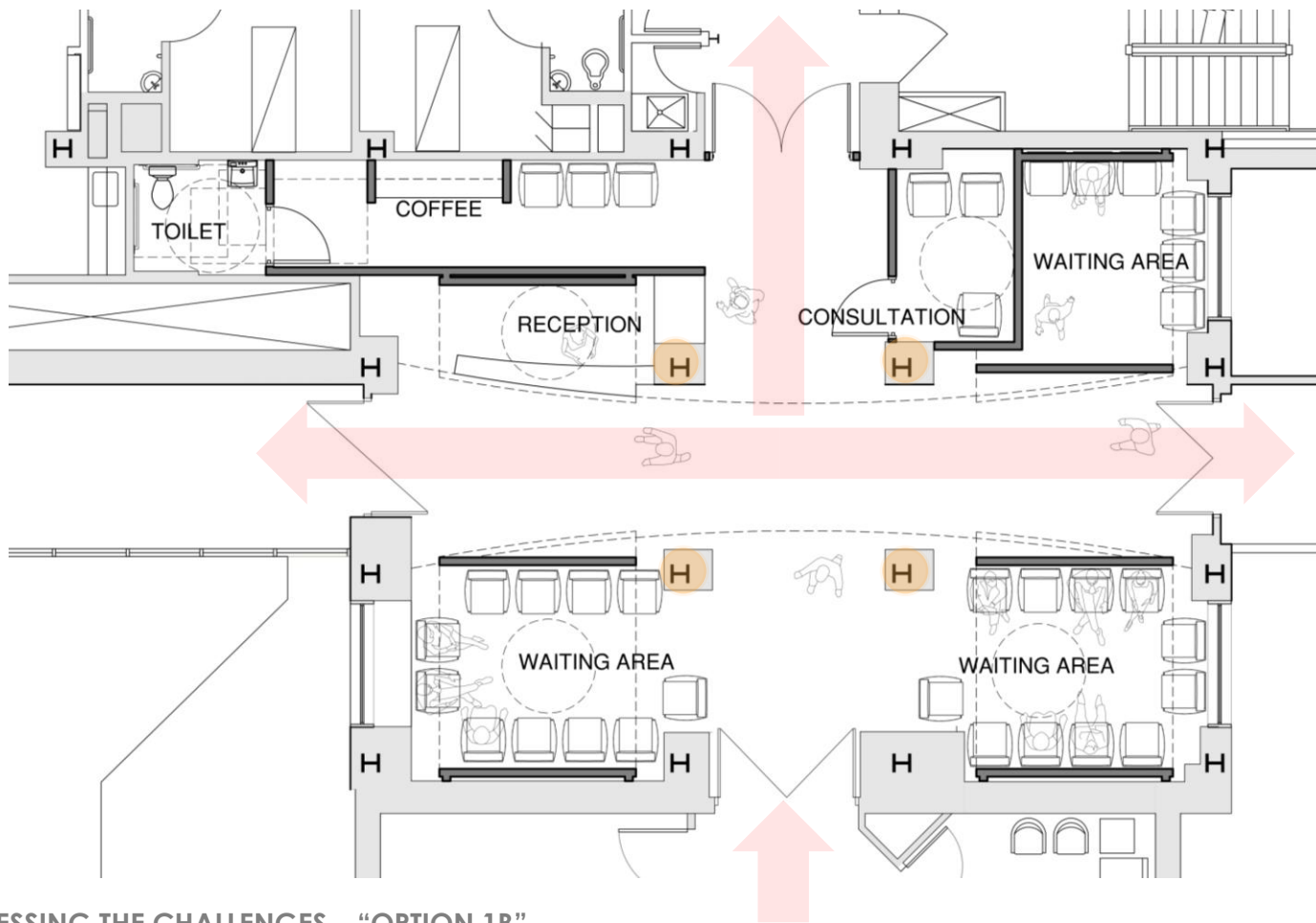

ADDRESSING THE CHALLENGES – "OPTION 1B"



Trinity Health  
Of New England  
Saint Mary's  
Hospital



Emergency Exit Only

Donor Wall

### ADDRESSING THE CHALLENGES – “OPTION 1A”

DESIGNPROCESS







Trinity Health  
Of New England  
Saint Mary's  
Hospital

DESIGNPROCESS

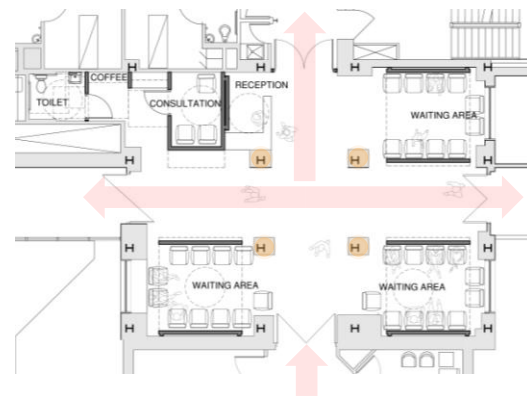
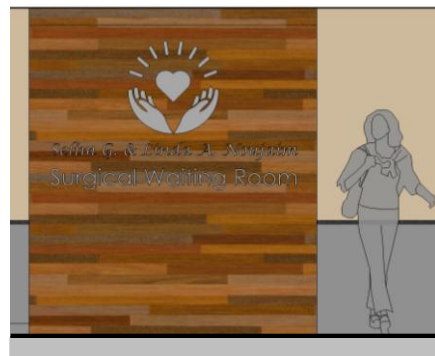

ADDRESSING THE CHALLENGES – “OPTION 1A”



Trinity Health  
Of New England  
Saint Mary's  
Hospital

DESIGNPROCESS

ADDRESSING THE CHALLENGES – “OPTION 1B”







Trinity Health  
Of New England  
Saint Mary's  
Hospital

DESIGNPROCESS

ADDRESSING THE CHALLENGES – “OPTION 1C”





Trinity Health  
Of New England  
Saint Mary's  
Hospital

# DISCUSSION



DISCUSSION

We are going with Option 1A in the attached slide deck.

The Donors that are funding the renovation are **Selim and Linda Noujaim**. They own a tool/manufacturing company in Waterbury and he also served in the CT state legislature for quote a while.